



# EV SERIES 50 HZ

VERTICAL MULTISTAGE PUMPS





# VERTICAL MULTISTAGE PUMPS

## FEATURES AND BENEFITS

### APPLICATIONS



Water Distribution,  
Pressure Boosting,  
Drinking water



Irrigation  
Water treatment plants  
Gardening, Sprinklers



Wash down unit  
Boiler Feed



Domestic, industrial and  
agricultural systems



Circulation of hot and  
cold water for heating,  
cooling, conditioning systems

### ROBUST AND RELIABLE

- Compact and solid structure
- Easy installation in-line ports
- All wetted parts in Stainless Steel
- Shaft bearing and journal sleeve made of tungsten carbide
- WRAS approved PPS (EV 1-3-6-10-15-20) / PTFE (EV 30-45-65-95)
- Easily replaceable cartridge mechanical seal, no need to disassemble the pump; for models higher than 4 kW no need to remove the motor
- Reduced service and maintenance time
- Replaceable Stainless Steel wear ring in the neck of the impeller (only for EV 30-45-65-95)

### HIGH QUALITY MATERIALS

- Stainless steel impeller and diffuser for corrosion resistance
- Standard mechanical seal (EN 12756 ex DIN 24960) WRAS approved; balanced version for EV 30-45-65-95
- Standard IE3 motor, size B14 up to 4 kW / size B5 from 5.5 kW and above
- Tungsten carbide intermediate bearing to stabilize the hydraulic with large number of stages

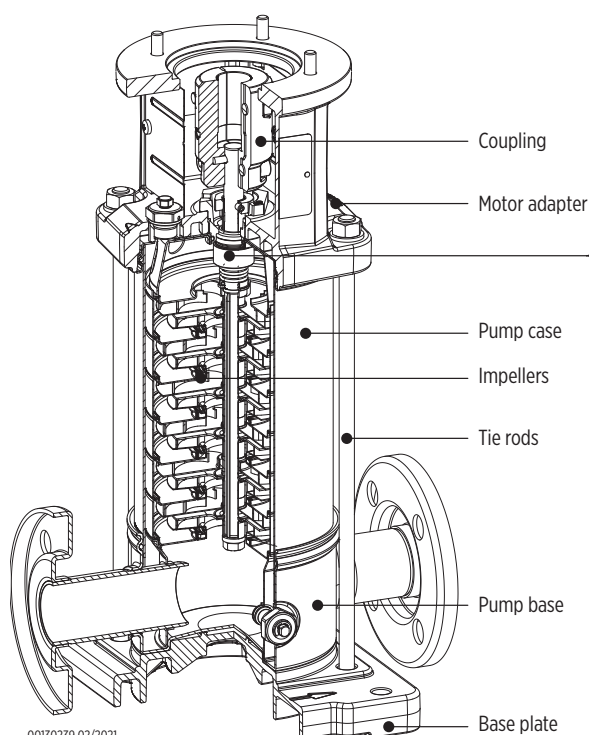

00130239 02/2021

#### CARTRIDGE MECHANICAL SEAL

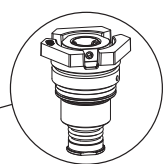

Unbalanced  
version

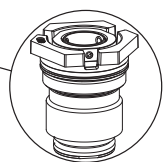

Balanced  
version

Vertical multistage pumps are rotodynamic pumps, not self-priming, assembled with one or more stages with radial or semiaxial (mixed) flow. The pump consists in a pump body, with in-line connections to the pipes, an external waterproof shell, an upper bracket that supports the motor. The bottom base plate allows the ground fixing. The structural integrity is guaranteed by the tie rods. The motor shaft and the pump shaft (driven shaft) are connected to each other by rigid, removable coupling. The rigid coupling can be equipped with a ball bearing to support the axial thrust (thrust assembly). The mechanical seal, cartridge type, is free from periodic maintenance.

## FAMILY CURVES

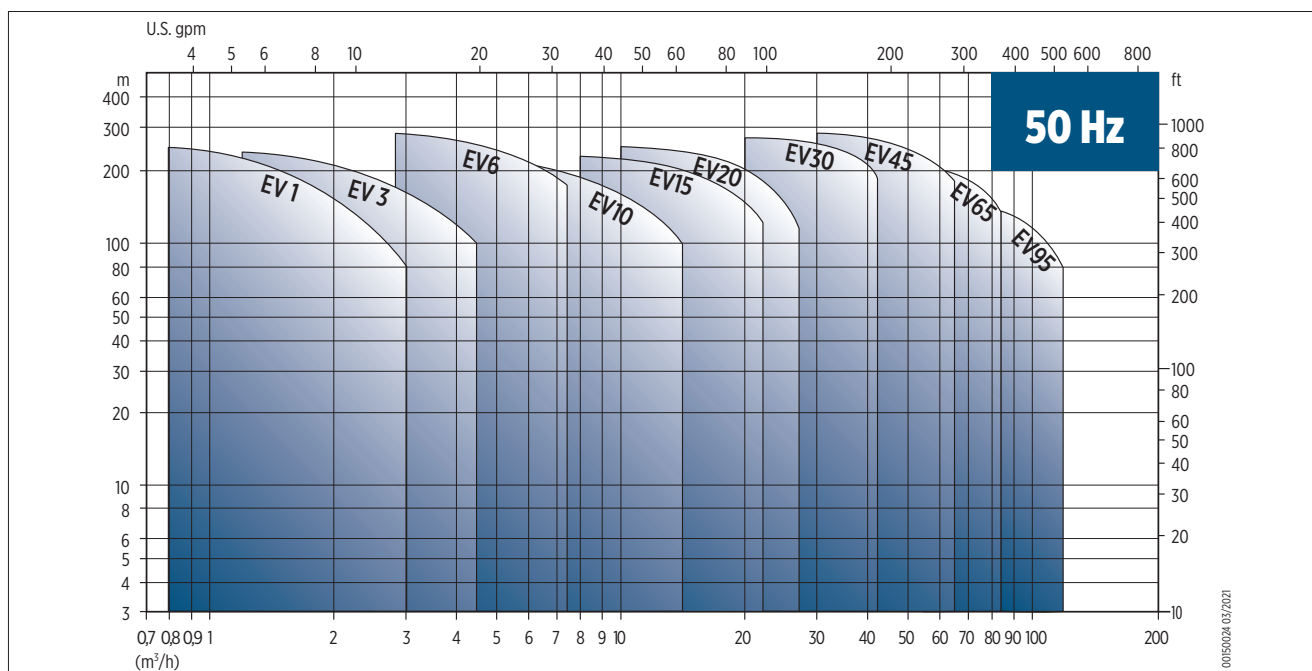

## PUMP IDENTIFICATION CODE

EV 30 / 15 F G 015 E1

- Motor voltage
- "Empty" (std version), "P" (passivation), "R" (overlapped outlets)
- "Empty" (std version), "H" (high pressure), "M" (oversized motor)
- "IE..." motor efficiency class IEC60034-30, where applicable
- Elastomer and mechanical seal material
- Mechanical seal: "Empty" (std version), "B" (balanced)
- Motor pole no.: "Empty" (2 poles), "4" (4 poles)
- Frequency: "5" (50 Hz); "6" (60 Hz)
- Motor type: "Empty" (pump without motor), "T" (three-phase), "M" (single-phase)
- Motor power (kW x 10)
- Material: "G" (cast iron/stainless steel); "I" (AISI304 / EN 1.4301); "N" (AISI316 / EN 1.4401)
- Flanges: "F" (round); "T" (oval); "V" (victaulic); "C" (clamp)
- Number of reduced impellers, "Empty" (none)
- Number of stages/impellers
- Rated flow in m³/h
- Pump model

00400091 01/2020

## GENERAL FEATURES

Model		1	3	6	10	15	20	30	45	65	95
Nominal flow [m³/h]		2	3	6	11	17	20	36	48	70	90
Maximum liquid temperature [°C]	Domestic uses	85 °C									
	Other uses	120 °C									
Max. D hydraulic [%]		47.8	57.1	64.6	68.5	69.0	69.0	75.4	76.3	78.4	79.4
Range [m³/h]		0.8 - 2.8	1.4 - 4.2	2.8 - 7.2	7.0 - 14.0	8.0 - 24.0	9.0 - 28.0	25.0 - 42.0	34.0 - 64.0	30.0 - 88.0	45.0 - 115.0
Max. pressure [bar]	Standard version	26	26	26	26	26	26	32	32	25	25
	Motor power [kW] (2 poles)	0.37 - 2.2	0.37 - 3.0	0.37 - 5.5	0.75 - 7.5	1.1 - 15	1.1 - 18.5	2.2 - 30.0	3.0 - 45.0	4.0 - 45.0	5.5 - 45.0
Material versions	G (cast-iron + AISI 304 SS)	-	-	-	-	-	-	•	•	•	•
	I (AISI 304 SS)	•	•	•	•	•	•	-	-	-	-
	N (AISI 316L SS)	•	•	•	•	•	•	•	•	•	•
	P (AISI 316L SS passivated)	•	•	•	•	•	•	•	•	•	•
Hydraulic connection (dimensions)	F (round flange) I (AISI 304 SS) version N (AISI 316L SS) version	DN 25 PN 25/40	DN 25 PN 25/40	DN 32 PN 25/40	DN 40 PN 25/40	DN 50 PN 25/40	DN 50 PN 25/40	-	-	-	-
	F (round flange) G (cast-iron) version N (AISI 316L SS) version	-	-	-	-	-	-	DN 65 PN16 - PN 25/40	DN 80 PN16 - PN 25/40	DN 100 PN16 - PN 25/40	DN 100 PN16 - PN 25/40
	T (oval flange) I (AISI 304 SS) version	Rp 1" (DN 25) PN 16	Rp 1" (DN 25) PN 16	Rp 1" (DN 25) PN 16	Rp 1" ½ (DN 40) PN 16	Rp 2" (DN 50) PN 16	Rp 2" (DN 50) PN 16	-	-	-	-
	V (Victaulic) N (AISI 316L SS) version	1" (DN 25) PN 25	1" (DN 25) PN 25	1" ¾ (DN 32) PN 25	1" ½ (DN 40) PN 25	2" (DN 50) PN 25	2" (DN 50) PN 25	-	-	-	-
	C (Clamp) N (AISI 316L SS) version	1" (DN 25) PN 25	1" (DN 25) PN 25	1" ¾ (DN 32) PN 25	1" ½ (DN 40) PN 25	2" (DN 50) PN 25	2" (DN 50) PN 25	-	-	-	-

"-" = not available

• = available