

Franklin Electric South Africa (Pty) Limited
 Head office and factory
 PO Box 8136, Edenglen, 1613, South Africa
 13 Engwena Road, Sebenza, Edenvale, 1610
 Tel: +27 11 723 6500
 Fax: +27 11 609 2417
 Website: www.franklin-electric.com
 E-mail: info@franklin-electric.co.za



Service and Support - Franklin Electric is the leading manufacturer of world-class pumping system solutions providing the highest quality, availability, service, innovation and value in the industry. Backed by unsurpassed expertise throughout Africa, these leading brands are ideal for various pumping applications.



Axial flow pumps

The Tsunami range of axial flow pumps are engineered to lift large volumes of water from rivers and irrigation channels.



Franklin Electric

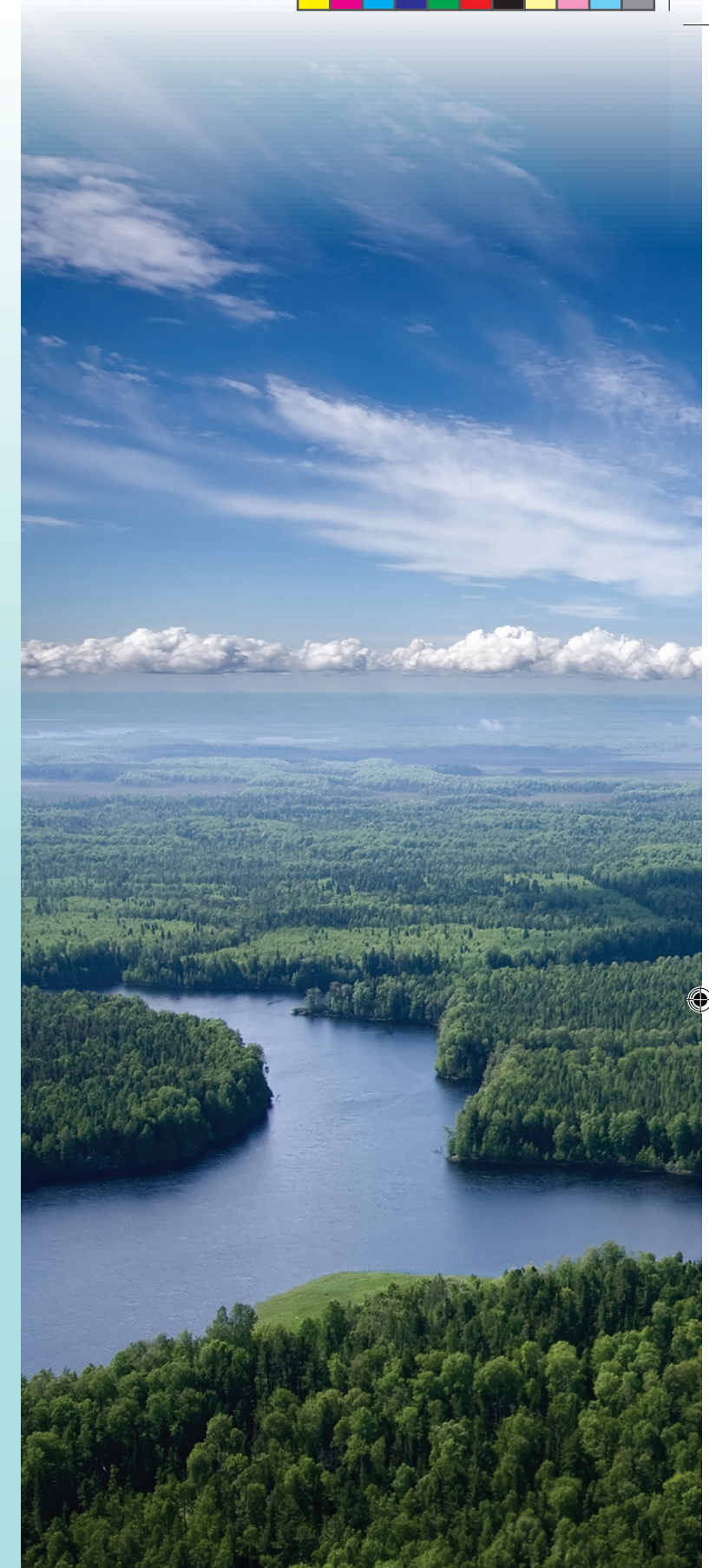

Features

- Low cost installation with minimal civil requirements
- Permanently submerged turbine
- Motor can be positioned well above the flood level
- No valves or non-return valves required
- No priming required
- Self-flushing
- High efficiencies
- Low load starting conditions
- Varying head conditions result in small variations in flow
- Range of materials of construction to suit various conditions
- Heavy-duty thrust assembly coupled either with a Hardy Spicer shaft or a right-angled gear drive
- Stainless steel shafts, impellers and impeller rings as standard materials of construction
- Simple and reliable.

Capabilities

The range of Tsunami axial flow pumps is capable of flows up to 2600 litres per second. Discharge head capabilities range from 1 to 110 metres.

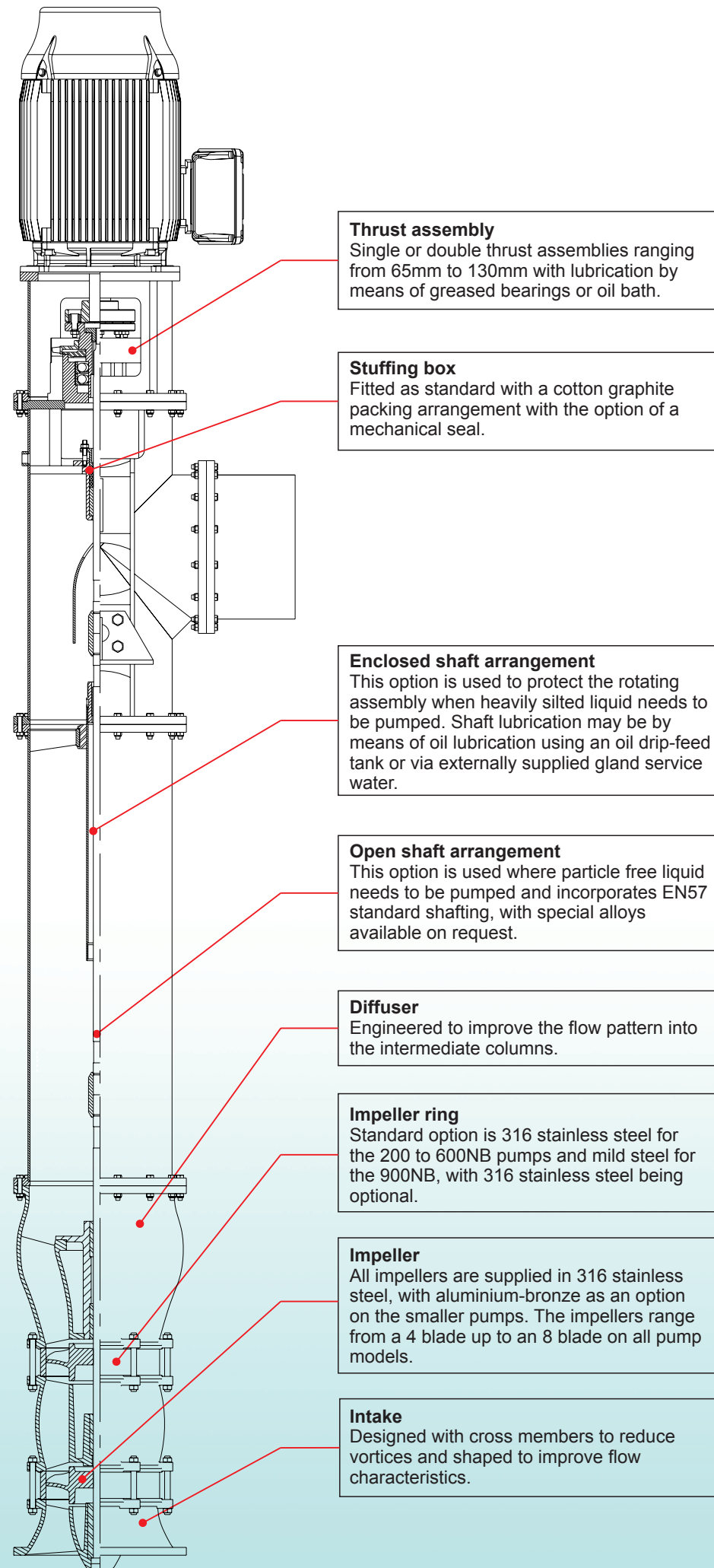
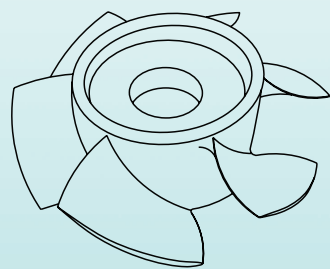

Ongoing Research and Development

As one of South Africa's largest pump manufacturers, Franklin Electric employs dedicated engineers to focus on the results of local and global research in the theory and practical application of axial flow pump technology. The pumps are wholly manufactured in South Africa. A comprehensive range of spare parts are stocked and expert service backup is readily available.

Efficient and Flexible

Standard, interchangeable components to suit any configuration and a full range of impellers greatly contribute to the flexibility of the Tsunami. Efficient at varying water levels, the pump's power unit remains at low load, even when pumping in full flood.

Applications

- Transfer of large volumes of water at relatively low heads
- Aqua-culture and other marine industries
- Effluent recycling within sewage works
- Features in water parks
- Backwash water from filters
- Water harvesting from rivers and dams
- Product transfer in process plants
- Flood irrigation.

Versatility

The Tsunami axial flow range can be configured for installation in horizontal, inclined or vertical applications.

